

## TCB

TecsPak crane bumpers are the proven and cost-effective choice for high load energy management systems, with excellent resistance to chemicals and humidity. These bumpers are designed to meet the minimum requirements of existing industry standards-OSHA and CMAA-through the use of a unique “Dual-concept for the device’s spring rate.”

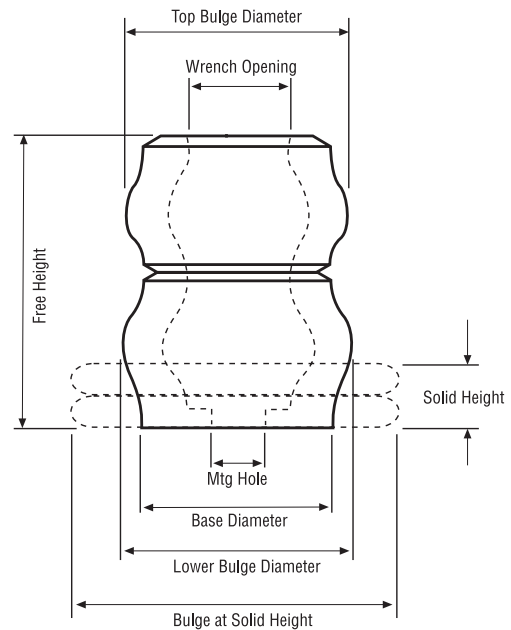

BUMPER	FREE HEIGHT	TOP/FREE BULGE	LOWER BULGE	WRENCH OPENING	BASE DIA.	MOUNTING HOLE	SOLID HEIGHT	BULGE @ SOLID HT.	RATED ENERGY CAPACITY (FT-LBS.)	PEAK DYNAMIC FORCE (LBS.)	SHIPPING WEIGHT (LBS.)
TCB-1B	3.12	2.43	2.50	1.09	2.04	0.54	0.69	3.50	330	18,000	0.35
TCB-2B	3.78	2.86	2.90	1.29	2.41	0.54	0.80	4.50	720	37,000	0.52
TCB-3B	3.68	3.28	3.28	1.45	2.70	0.54	0.80	5.00	1,400	82,000	0.62
TCB-4B	2.09	4.25	N/A	1.11	3.02	0.54	0.90	5.25	1,400	102,000	0.78
TCB-5B	2.67	3.48	N/A	1.26	2.64	0.54	0.75	4.88	1,200	112,000	0.56
TCB-6B	3.20	3.94	N/A	1.72	3.59	0.54	1.00	5.88	1,300	57,000	1.13
TCB-7B	2.19	3.38	N/A	1.46	3.06	0.54	0.67	5.25	890	71,000	0.56
TCB-8B	3.85	4.00	N/A	1.60	3.22	0.80	1.38	5.50	1,450	50,000	1.13
TCB-9B	4.63	5.50	5.75	1.72	3.90	0.80	2.00	7.50	6,140	185,000	3.28
TCB-10B	4.18	5.35	N/A	1.72	4.16	0.80	1.63	7.00	3,130	112,000	2.38
TCB-11B	5.08	4.62	N/A	1.72	3.92	0.80	1.25	7.38	2,730	110,000	2.21
TCB-12B	7.38	5.26	5.28	2.52	4.62	0.80	1.63	8.44	5,375	160,000	3.44
TCB-13B	4.54	5.38	N/A	1.68	4.44	0.80	1.00	8.50	4,675	205,000	2.38
TCB-14B	6.54	6.60	N/A	2.82	5.77	0.80	1.65	10.25	7,440	220,000	5.13
TCB-15B	8.90	6.00	6.00	2.92	5.15	0.80	1.88	9.50	5,350	135,000	5.13
TCB-16B	9.50	5.84	5.88	2.90	5.19	0.80	2.50	8.81	6,530	126,000	5.69
TCB-17B	9.92	6.90	6.93	3.40	5.90	0.80	2.13	11.00	9,375	192,000	7.94