

TecsPak® Bumpers

Typical applications include:

GBA

- Sawmill and Debarking Equipment
- Mining/Heavy Construction Machinery
- Gantry/Trolley, Shipyard Bulkhead and Heavy Door Bumpers
- Steel Mill Press Room, Stamping and Foundry Equipment

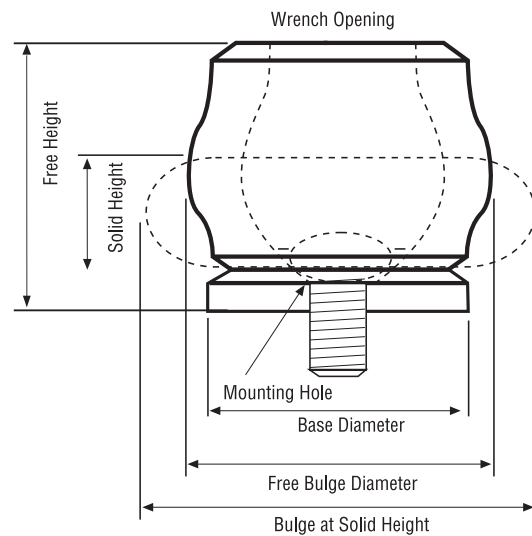

BUMPER	FREE HEIGHT	FREE BULGE	WRENCH OPENING	BASE DIA.	MOUNTING HOLE	SOLID HEIGHT	BULGE @ SOLID HT.	RATED ENERGY CAPACITY (IN-LBS.)	PEAK DYNAMIC FORCE (LBS.)	SHIPPING WEIGHT (OZ.)
GBA-1	0.76	0.85	0.41	0.75	0.31	0.40	1.07	100	700.00	0.16
GBA-2	1.01	1.11	0.56	0.98	0.31	0.53	1.43	250	1,200	0.37
GBA-3	1.18	1.35	0.66	1.16	0.31	0.63	1.70	400	2,000	0.62
GBA-4	1.31	1.47	0.72	1.28	0.31	0.69	1.88	550	2,400	0.86
GBA-5	1.37	1.55	0.80	1.35	0.42	0.73	1.97	700	2,500	1.00
GBA-6	1.49	1.70	0.79	1.48	0.42	0.80	2.15	900	3,600	1.40
GBA-7	1.62	1.83	0.93	1.61	0.55	0.86	2.33	1100	3,300	1.70
GBA-8	1.77	1.96	1.02	1.71	0.55	0.92	2.51	1400	3,800	2.00
GBA-9	1.86	2.14	1.04	1.85	0.55	0.99	2.69	1700	5,000	2.20
GBA-10	2.02	2.25	1.16	1.97	0.55	1.06	2.86	2000	5,000	3.10
GBA-11	2.11	2.43	1.23	2.08	0.55	1.12	3.05	2500	5,300	3.70
GBA-12	2.26	2.54	1.30	2.23	0.55	1.19	3.22	3000	6,100	4.60
GBA-13	2.38	2.70	1.38	2.35	0.55	1.25	3.40	3500	6,600	5.10
GBA-14	2.54	2.81	1.41	2.46	0.81	1.32	3.58	4000	7,500	6.10
GBA-15	2.72	3.10	1.57	2.71	0.79	1.45	3.94	5000	8,300	7.80
GBA-16	2.91	3.22	1.69	2.82	0.81	1.52	4.12	6000	8,700	9.10
GBA-17	3.00	3.35	1.70	2.95	0.81	1.58	4.30	7000	9,600	10.60
GBA-18	3.13	3.50	1.78	3.07	0.81	1.65	4.48	8000	10,800	11.80
GBA-19	3.37	3.83	1.92	3.34	0.81	1.78	4.83	10000	14,000	14.90
GBA-20	3.98	4.56	2.26	3.39	0.81	2.11	5.73	17000	18,500	26.10